

CLEAN PROCESSES REGULATOR PRSTC15

FOR PHARMACEUTICAL AND BIO-TECHNOLOGY SYSTEMS

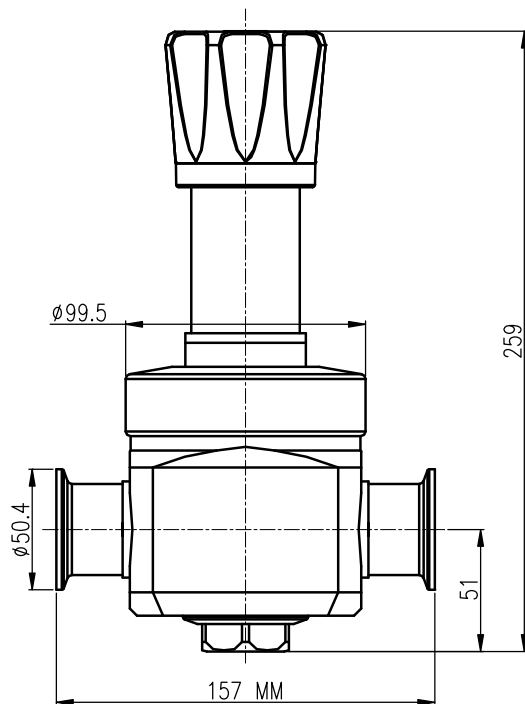

PRSTC15



MAIN FEATURES

- ss 316L construction
- easy to polish
- diaphragm sensing
- o.d. tri-clamp ferrules
- compliance with FDA/USP Class VI
- internal finish maximal 0,4 µm
- shell design according to EN 12516
- ferrules compatible with Tri-clamp®

CHARACTERISTICS

Inlet pressure	: 16 bar
Outlet pressure range	: 0,3 - 9 bar
Seat diameter	: 17 mm
Cv (Kv)	: 5.48 (4.66)
Materials:	
• Body & Trim	: ss 316L
• Springhousing	: ss 316L
• Seat insert	: epdm
• Diaphragm	: epdm
Weight	: 4,7 kg
Temperature	: -35 to +140°C

CONNECTIONS

US/BS o.d. ferrules are standard.
Adaptor ferrules for DIN/ISO tubing are available.
Clamps are available.

CLEANING

This regulator is ultrasonically cleaned and degreased.
Cleaning based on
ASTM-G93 Level C/ CGA 4.1.is optional.



Swagelok regulators are not "Safety Accessories" as defined in the Pressure Equipment Directive 97/23/EC:



Do not use the regulator as a shut off device.

RHPS Series

Swagelok

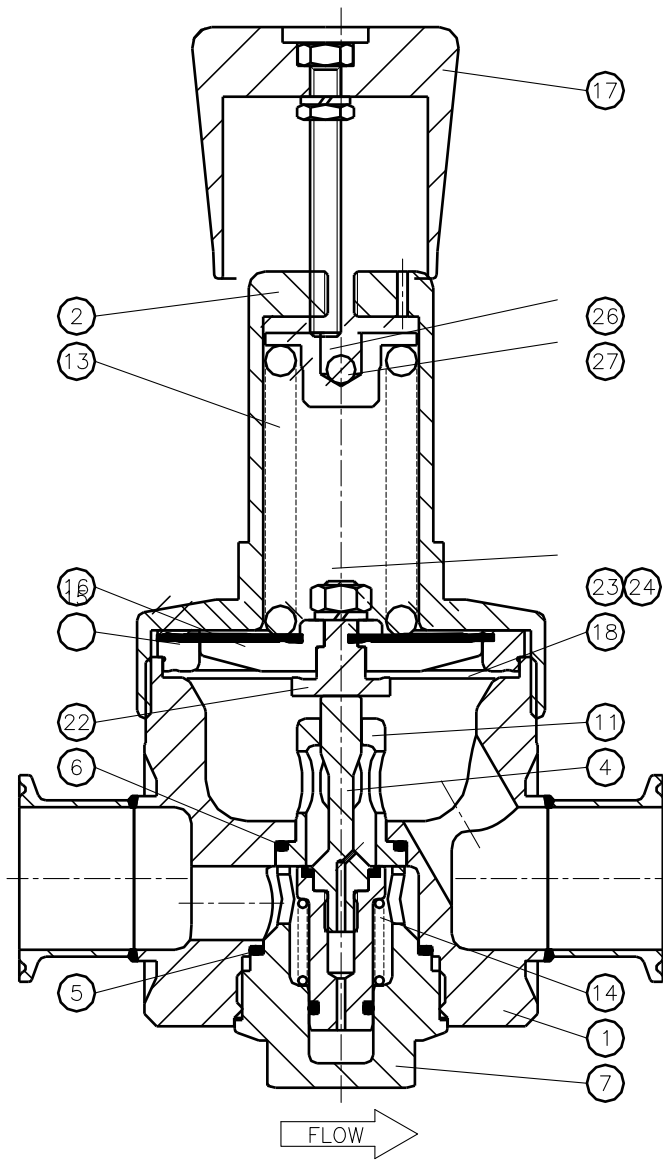

ORDERING INFORMATION
 example: PRSTC12-02-2-EEE

PRS	TC12	- 02	- 2	- E	E	E
series / inlet	port	body material	outlet range	o-rings	diaphragm	seat
PRS = 16 bar	TC15 = 1½" OD ferrule	02 = ss316L	1 = 0,3 – 3 bar 2 = 1 – 9 bar	E = epdm	E = epdm	E = epdm

Red text identifies an example ordering number.

Safe Product Selection

When selecting a product, the total system design must be considered to ensure safe, trouble-free performance. Function, material compatibility, adequate ratings, proper installation, operation, and maintenance are the responsibilities of the system designer and user.

RHPS, Swagelok—TM Swagelok Company
 © 2010 Swagelok Company
 Printed in U.S.A., OM
 June 2010, R0
 MS-02-422-E

RHPS Series



FLOW CURVE PRSTC12

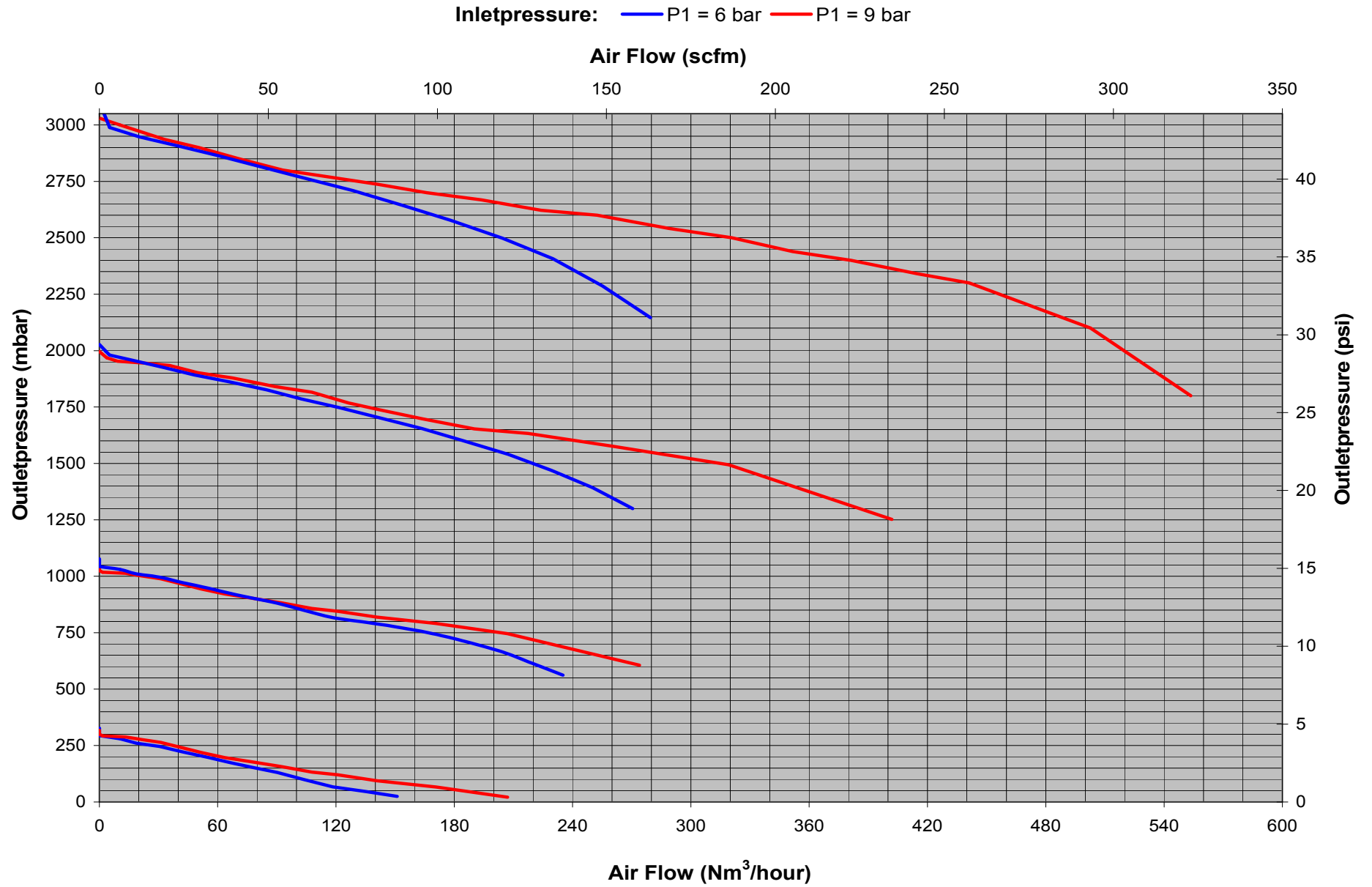

RHPS Series

